



CoreLine Projector gen2

ST151T LED30S/930 WB BK

38 degree(s), 930 warm white, Power supply unit (On/Off),
Black

The well-known CoreLine Projector with its latest generation has undergone important design and performance improvement, raising the bar even higher and setting a new standard for track projectors used in retail and hospitality applications.

Warnings and Safety

- The luminaire should be mounted outside of arm's reach
- The luminaire should be installed by a qualified electrician and wired in accordance with the latest IEE electrical regulations or the national requirements

Product data

General Information	
Light source replaceable	No
Number of gear units	Unit
Driver included	Yes
Lighting Technology	LED
Value ladder	Value
CE mark	Yes
Warranty period	5 years
Flammability mark	-
ENEC mark	ENEC mark
Glow-wire test	Temperature 650 °C, duration 30 s
EU RoHS compliant	Yes

Light Technical	
Luminous Flux	3,000 lm
Saturated Red (R9)	>50
Correlated Colour Temperature	3000 K
Luminous efficacy (rated) (nom.)	100 lm/W
Colour rendering index (CRI)	>90
Flickering value (PstLM)	1
Stroboscopic effect	1.6
Beam angle of light source	38 degree(s)
Light source colour	930 warm white
Optic type	Wide beam
Luminaire light beam spread	38°

CoreLine Projector gen2

Unified Glare Rating (CEN)	19
----------------------------	----

Operating and Electrical	
Input Voltage	220 to 240 V
Line Frequency	50 or 60 Hz
Initial CLO power consumption	30 W
Average CLO power consumption	30 W
Inrush current	43.8 A
Inrush time	0.0115 ms
Power Consumption	30 W
Power Factor (Fraction)	0.9
Connection	3C Track
Cable	-
Number of products on MCB of 16 A type B	30

Temperature	
Ambient temperature range	-20 to +40 °C

Controls and Dimming	
Dimmable	No
Driver/power unit/transformer	Power supply unit (On/Off)
Constant light output	No

Mechanical and Housing	
Housing material	Aluminium
Reflector material	-
Optic material	Polycarbonate
Optical cover/lens material	Polycarbonate
Fixation material	-
Housing Colour	Black
Optical cover/lens finish	-
Overall length	207 mm
Overall width	87 mm
Overall height	125 mm
Overall diameter	80 mm
Dimensions (height x width x depth)	125 x 87 x 207 mm

Approval and Application	
Ingress protection code	IP20 [Finger-protected]
Mech. impact protection code	IK03 [0.3 J]
Sustainability rating	-
Protection class IEC	Safety class I
Photobiological risk	Photobiological risk group 0 @200mm to EN62778
Photobiological risk specification	0.2 m

Initial Performance (IEC Compliant)	
Luminous flux tolerance	+/-10%
Initial chromaticity	(0.4355, 0.4045) SDCM <4
Power consumption tolerance	+/-10%

Over Time Performance (IEC Compliant)	
Control gear failure rate at median useful life	0.05 %
50,000 h	
Lumen maintenance at median useful life*	L70
50,000 h	

Application Conditions	
Performance ambient temperature Tq	25 °C
Maximum dim level	Not applicable
Suitable for random switching	No

Product Data	
Full EOC	871951452859899
Order product name	ST151T LED30S/930 WB BK
Order code	52859899
SAP numerator – quantity per pack	1
Numerator – packs per outer box	10
Material no. (12 NC)	911401846982
Full product name	ST151T LED30S/930 WB BK
EAN/UPC – Case	8719514528673
EAN/UPC – Product/Case	8719514528598

Dimensional drawing

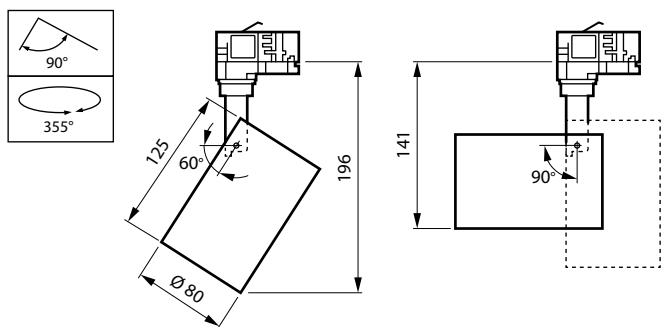

CoreLine Projector gen2

